

Digital Alpha VME 2100 Vertical Rackmount Front Bezel Installation Information

Introduction

The front bezel kit for the Digital Alpha VME 2100 vertical rackmount chassis contains the front bezel, four latch brackets, and eight 4-40 flathead screws. The four latch brackets *must* be installed on the chassis before the chassis is installed in the RETMA or IEC cabinet.

Installing the Front Bezel

Use Figure 1 and Figure 2 along with the following procedure to install the front bezel on the Digital Alpha VME 2100 vertical rackmount chassis:

1. Refer to Figure 1 and insert a latch bracket ❶ through each of the four vertical slots ❷ in the chassis frame. Ensure that the latch mechanism is toward the outside edge of the chassis frame when the bracket is inserted through the slot.
2. Refer to Figure 1 and secure each latch bracket to the side of the chassis with two 4-40 flathead screws ❸.
3. Set the front bezel aside until the chassis has been installed in the RETMA or IEC cabinet.
4. Refer to the *Digital Alpha VME 2100 Owner's Guide* and perform the vertical rackmount Digital Alpha VME 2100 installation procedure.

NOTE

If an optional removable media storage device is installed in the Digital Alpha VME 2100 chassis, remove the corresponding blank insert on the front bezel before installing the front bezel on the chassis.

5. After installing the vertical rackmount chassis in the cabinet, refer to Figure 2 and grasp the front bezel ❹ by the flip-down pull tabs ❺ or by the sides.
6. Refer to Figure 2 and align the four strikes ❻ on the front bezel with the four latches ❼ on the chassis.
7. Press the front bezel onto the chassis until the four strikes snap into the four latches.

© Digital Equipment Corporation 1995. All Rights Reserved.

Digital Equipment Corporation makes no representations that the use of its products in the manner described in this publication will not infringe on existing or future patent rights, nor do the descriptions contained in this publication imply the granting of licenses to make, use, or sell equipment or software in accordance with the description.

Figure 1: Installing the Latch Brackets

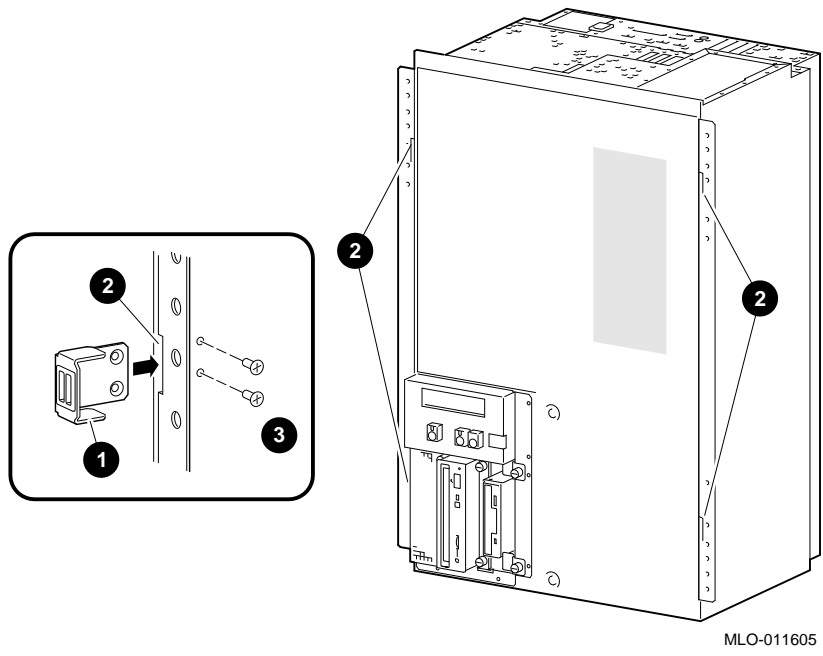

Figure 2: Installing the Front Bezel

